

HSM075 30/37

Internal grinding spindle

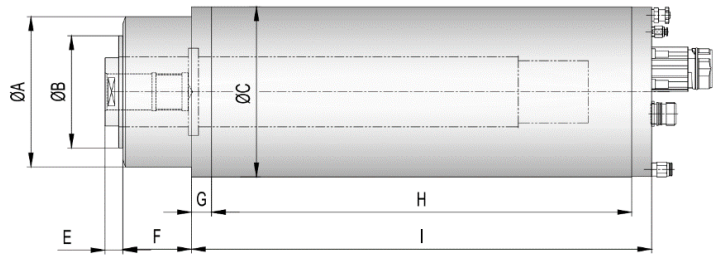

Tool interface / upon request

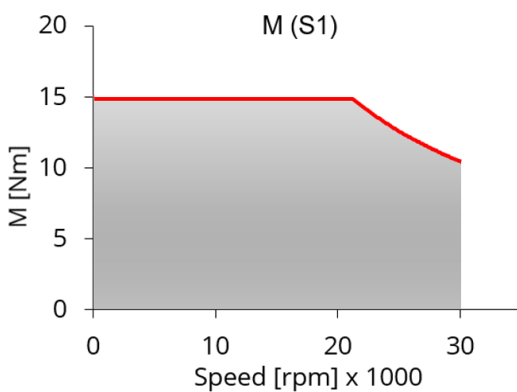
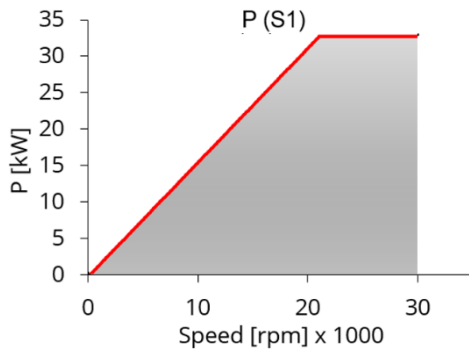
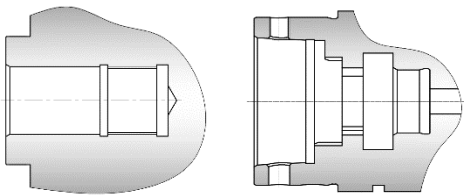

Technical data

Front spindle housing - \varnothing	A	[mm]
	B	[mm]
Main spindle housing - \varnothing	C	[mm]
Total spindle length (E+F+I)		[mm]
Nominal speed	n_{nom}	[rpm]
Maximum speed	n_{max}	[rpm]
Tool interface		
Cylindrical housing		
Housing with flange		
Block housing		
Sealing air with labyrinth		
Coolant feed trough shaft		

HSM075 30/37

150
120
150
510
20 600
29 700
Upon request
Standard
Optional
Upon request
Standard
Upon request

Power/torque characteristic

Values at nominal speed		
Power	P_{s1}	[kW]
Torque	M_{s1}	[Nm]
Voltage	U	[V]
Current	I	[A]
Values at maximum speed		
Power	P_{s1}	[kW]
Torque	M_{s1}	[Nm]
Voltage	U	[V]
Current	I	[A]

33
15,1
350
76
33
10,6
350
69

Electrical connection

Plug type		
Speed sensor		
Rotary encoder		
Temperature sensor		
Vibration sensor		

Straight / angled
Upon request
Upon request
Upon request
Upon request

Special sensors

Spindle shaft displacement		
Data logger		

Upon request
Upon request

HSM075 45/25

Internal grinding spindle

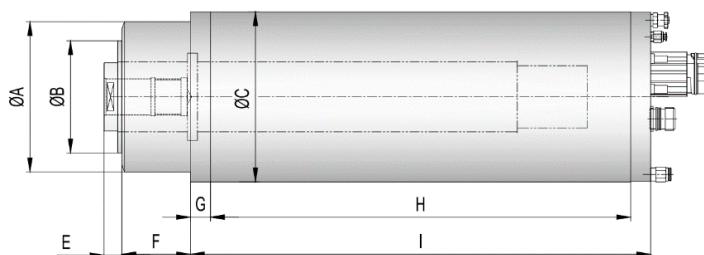

Tool interface / upon request

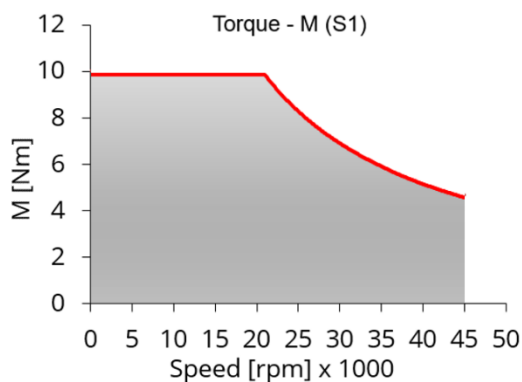
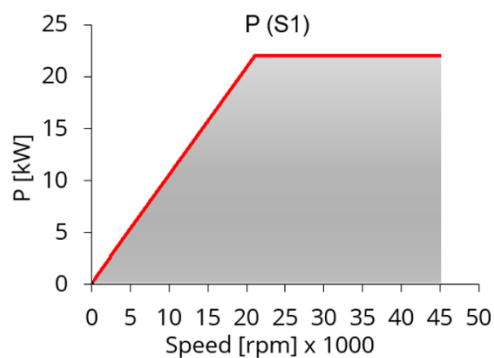
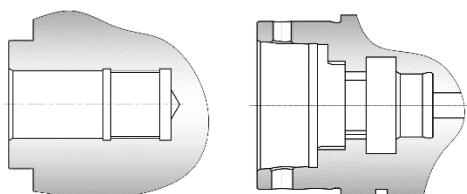

Technical data

Front spindle housing - Ø	A	[mm]
	B	[mm]
Main spindle housing - Ø	C	[mm]
Total spindle length (E+F+I)		[mm]
Nominal speed	n_{nom}	[rpm]
Maximum speed	n_{max}	[rpm]
Tool interface		
Cylindrical housing		
Housing with flange		
Block housing		
Sealing air with labyrinth		
Coolant feed trough shaft		

HSM075 45/25

120
90
150
450
20 700
44 500
Upon request
Standard
Optional
Upon request
Standard
Upon request

Power/torque characteristic

Values at nominal speed		
Power	P_{s1}	[kW]
Torque	M_{s1}	[Nm]
Voltage	U	[V]
Current	I	[A]
Values at maximum speed		
Power	P_{s1}	[kW]
Torque	M_{s1}	[Nm]
Voltage	U	[V]
Current	I	[A]

32
10,2
286
61
22
4,7
350
48

Electrical connection

Plug type		
Speed sensor		
Rotary encoder		
Temperature sensor		
Vibration sensor		

Straight / angled
Upon request
Upon request
Upon request
Upon request

Special sensors

Spindle shaft displacement		
Data logger		

Upon request
Upon request

HSM075 45/36

Internal Grinding spindle

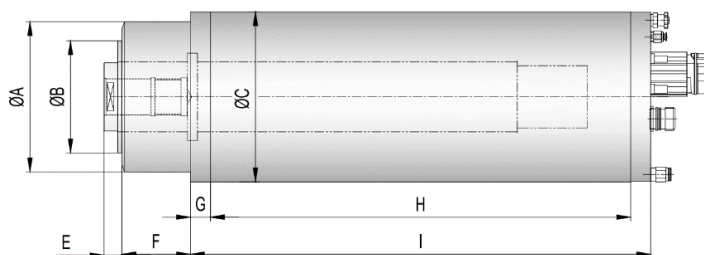

Tool interface / upon request

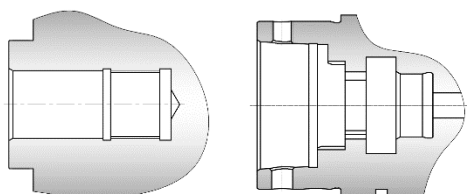

Power - P(S1)

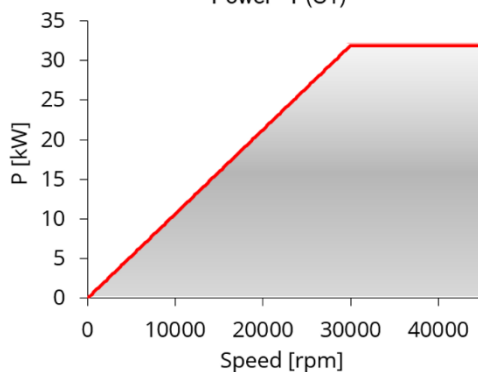

Torque - M (S1)

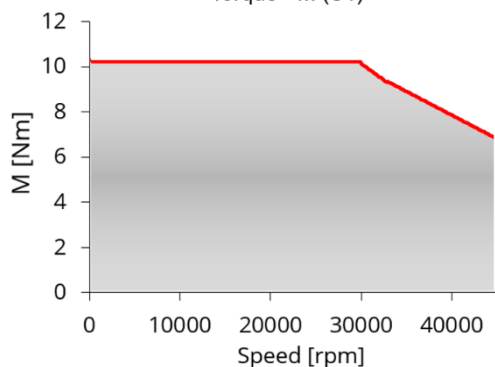

Technical data

Front spindle housing - Ø	A	[mm]
	B	[mm]
Main spindle housing - Ø	C	[mm]
Total spindle length (E+F+I)		[mm]
Nominal speed	n_{nom}	[rpm]
Maximum speed	n_{max}	[rpm]
Tool interface		
Cylindrical housing		
Housing with flange		
Block housing		
Sealing air with labyrinth		
Coolant feed trough shaft		

HSM075 45/36

	120
	90
	150
	450
	29 600
	45 000
	Upon request
	Standard
	Optional
	Upon request
	Standard
	Upon request

Power/torque characteristic

Values at nominal speed		
Power	P_{s1}	[kW]
Torque	M_{s1}	[Nm]
Voltage	U	[V]
Current	I	[A]
Values at maximum speed		
Power	P_{s1}	[kW]
Torque	M_{s1}	[Nm]
Voltage	U	[V]
Current	I	[A]

	32
	10,3
	321
	75
	32
	6,9
	350
	69

Electrical connection

Plug type		
Speed sensor		
Rotary encoder		
Temperature sensor		
Vibration sensor		

	Straight / angled
	Upon request
	Upon request
	Upon request
	Upon request

Special sensors

Spindle shaft displacement		
Data logger		

	Upon request
	Upon request