

# HSM085 18/34

## Inner grinding spindle

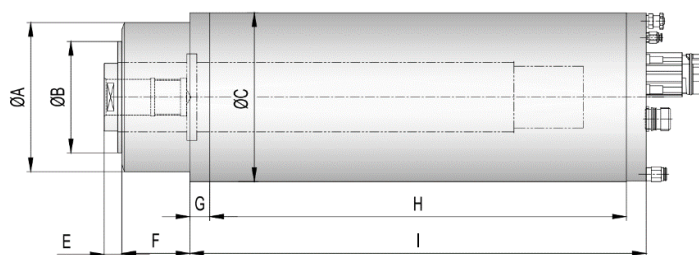

### Tool interface / upon request

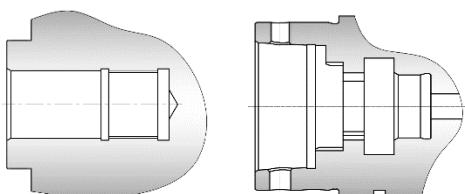

Power - P(S1)

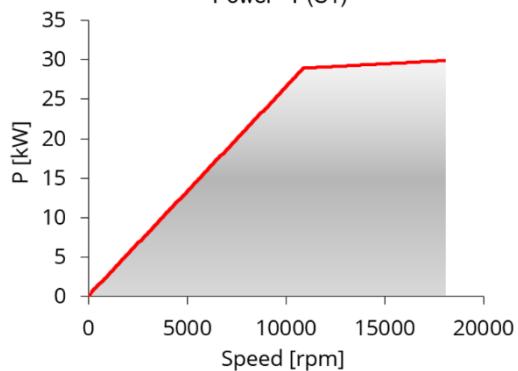

Torque - M (S1)

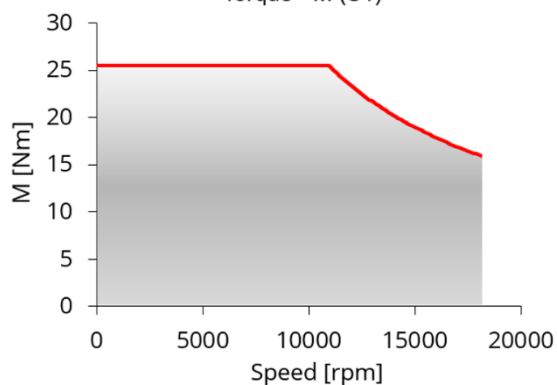

### Technical data

|                              |                  |       |
|------------------------------|------------------|-------|
| Front spindle housing - Ø    | A                | [mm]  |
|                              | B                | [mm]  |
| Main spindle housing - Ø     | C                | [mm]  |
| Total spindle length (E+F+I) |                  | [mm]  |
| Nominal speed                | n <sub>nom</sub> | [rpm] |
| Maximum speed                | n <sub>max</sub> | [rpm] |
| Tool interface               |                  |       |
| Cylindrical housing          |                  |       |
| Housing with flange          |                  |       |
| Block housing                |                  |       |
| Sealing air with labyrinth   |                  |       |
| Coolant feed trough shaft    |                  |       |

### HSM085 18/34

|              |
|--------------|
| 150          |
| 110          |
| 170          |
| 480          |
| 10 800       |
| 18 000       |
| Upon request |
| Standard     |
| Optional     |
| Upon request |
| Standard     |
| Upon request |

### Power/torque characteristic

| Values at nominal speed |                 |      |
|-------------------------|-----------------|------|
| Power                   | P <sub>s1</sub> | [kW] |
| Torque                  | M <sub>s1</sub> | [Nm] |
| Voltage                 | U               | [V]  |
| Current                 | I               | [A]  |
| Values at maximum speed |                 |      |
| Power                   | P <sub>s1</sub> | [kW] |
| Torque                  | M <sub>s1</sub> | [Nm] |
| Voltage                 | U               | [V]  |
| Current                 | I               | [A]  |

|      |
|------|
| 29   |
| 25,6 |
| 350  |
| 62   |
| 30   |
| 16,2 |
| 350  |
| 61   |

### Electrical connection

|                    |  |  |
|--------------------|--|--|
| Plug type          |  |  |
| Speed sensor       |  |  |
| Rotary encoder     |  |  |
| Temperature sensor |  |  |
| Vibration sensor   |  |  |

|                   |
|-------------------|
| Straight / angled |
| Upon request      |
| Upon request      |
| Upon request      |
| Upon request      |

### Special sensors

|                            |  |  |
|----------------------------|--|--|
| Spindle shaft displacement |  |  |
| Data logger                |  |  |

|              |
|--------------|
| Upon request |
| Upon request |

# HSM085 24/35

## Internal grinding spindle

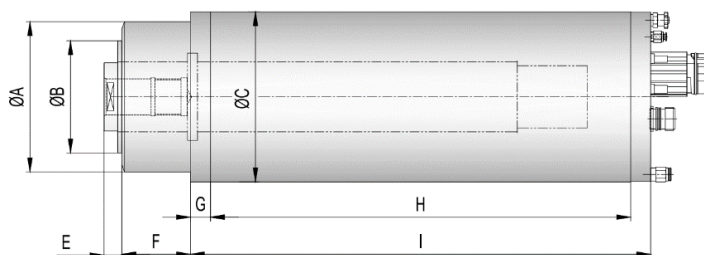

### Tool interface / upon request

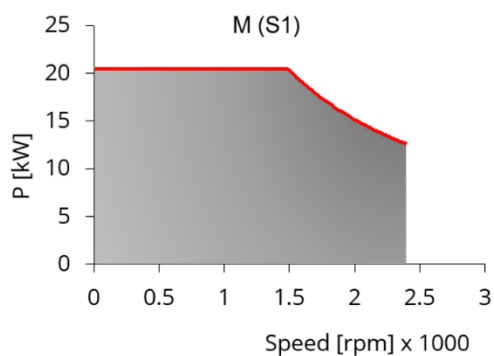
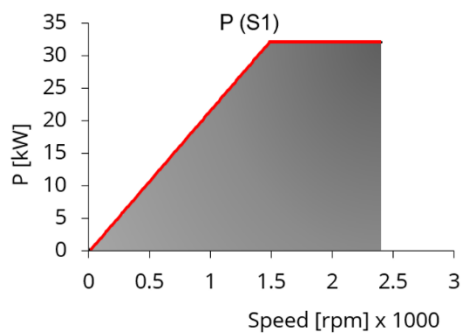
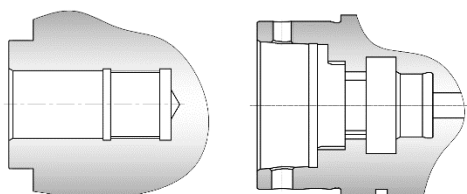

### Technical data

|                              |           |       |
|------------------------------|-----------|-------|
| Front spindle housing - Ø    | A         | [mm]  |
|                              | B         | [mm]  |
| Main spindle housing - Ø     | C         | [mm]  |
| Total spindle length (E+F+I) |           | [mm]  |
| Nominal speed                | $n_{nom}$ | [rpm] |
| Maximum speed                | $n_{max}$ | [rpm] |
| Tool interface               |           |       |
| Cylindrical housing          |           |       |
| Housing with flange          |           |       |
| Block housing                |           |       |
| Sealing air with labyrinth   |           |       |
| Coolant feed trough shaft    |           |       |

### HSM085 24/35

|              |
|--------------|
| 150          |
| 100          |
| 170          |
| 410          |
| 14 900       |
| 23 800       |
| Upon request |
| Standard     |
| Optional     |
| Upon request |
| Standard     |
| Upon request |

### Power/torque characteristic

| Values at nominal speed |          |      |
|-------------------------|----------|------|
| Power                   | $P_{s1}$ | [kW] |
| Torque                  | $M_{s1}$ | [Nm] |
| Voltage                 | U        | [V]  |
| Current                 | I        | [A]  |
| Values at maximum speed |          |      |
| Power                   | $P_{s1}$ | [kW] |
| Torque                  | $M_{s1}$ | [Nm] |
| Voltage                 | U        | [V]  |
| Current                 | I        | [A]  |

|      |
|------|
|      |
| 32   |
| 20,6 |
| 350  |
| 69   |
|      |
| 32   |
| 12,9 |
| 350  |
| 65   |

### Electrical connection

|                    |  |  |
|--------------------|--|--|
| Plug type          |  |  |
| Speed sensor       |  |  |
| Rotary encoder     |  |  |
| Temperature sensor |  |  |
| Vibration sensor   |  |  |

|                   |
|-------------------|
| Straight / angled |
| Upon request      |
| Upon request      |
| Upon request      |
| Upon request      |

### Special sensors

|                            |  |  |
|----------------------------|--|--|
| Spindle shaft displacement |  |  |
| Data logger                |  |  |

|              |
|--------------|
| Upon request |
| Upon request |